

LBC 3095/15 Pendant Sphere Loudspeaker

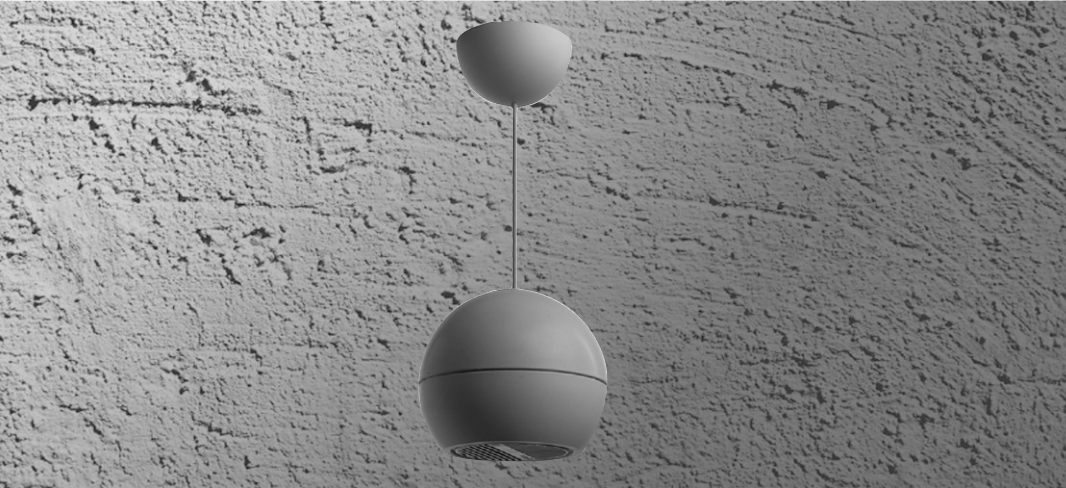

Security Systems



- Suitable for speech and music reproduction
- Simple power setting
- 5 m fixed connection cable
- Splash-waterproof type
- Robust self-extinguishing ABS enclosure to UL 94V0
- Complies with international installation and safety regulations

The LBC 3095/15 is a pendant sphere designed to be suspended from the ceiling via its connecting cable. The pleasing shape and neutral color make the pendant sphere models interesting architectural features in their own right.

Functions

The pendant sphere is splash waterproof and suitable for outdoor use and in environments with high humidity levels such as swimming pools.

Their excellent sound spread makes them ideal for use in buildings with high ceilings such as hypermarkets and superstores.

The enclosures are made from high-impact self-extinguishing ABS (acc. to class UL 94V0) and are colored off-white. The pendant sphere is designed to be suspended from its color-matched connecting cable (easy to shorten for desired height). A cable clamp and ceiling cover are supplied.

They are not recommended for use in windy environments.

Parts Included

Quantity	Components
1	LBC 3095/15 Pendant Sphere
1	Cable Clamp
1	Ceiling Cover

Certifications and Approvals

All Bosch loudspeakers are designed to withstand operating at their rated power for 100 hours in accordance with IEC 268-5 Power Handling Capacity (PHC) standards. Bosch has also developed the Simulated Acoustical Feedback Exposure (SAFE) test to demonstrate that they can withstand two times their rated power for short durations. This ensures extra reliability under extreme conditions, leading to higher customer satisfaction, longer operating life, and much less chance of failure or performance deterioration.

All plastic parts are manufactured from self-extinguishing high-impact ABS material (according to UL 94V0). In common with all Bosch products, care is taken to meet high safety standards. These sound projectors comply with all the relevant safety and installation regulations of EN 60065.

Water protection

acc. to EN 60529 IPx3

Installation/Configuration Notes

All units are supplied with a color-coded four-core connecting cable with each color connected to a different primary tap on the 100 V matching transformer. This allows nominal full-power, half-power or quarter-power radiation to be selected (i.e. in 3 dB steps).

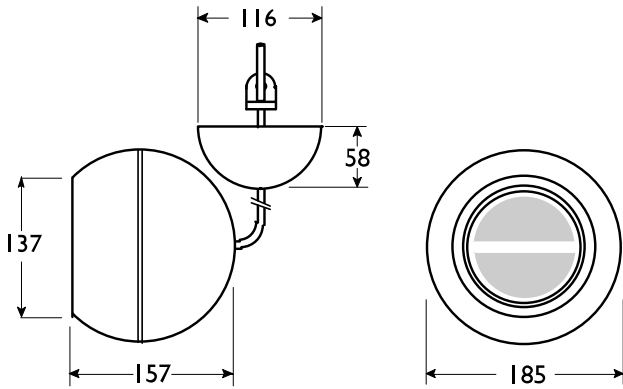

Dimensions (in mm)

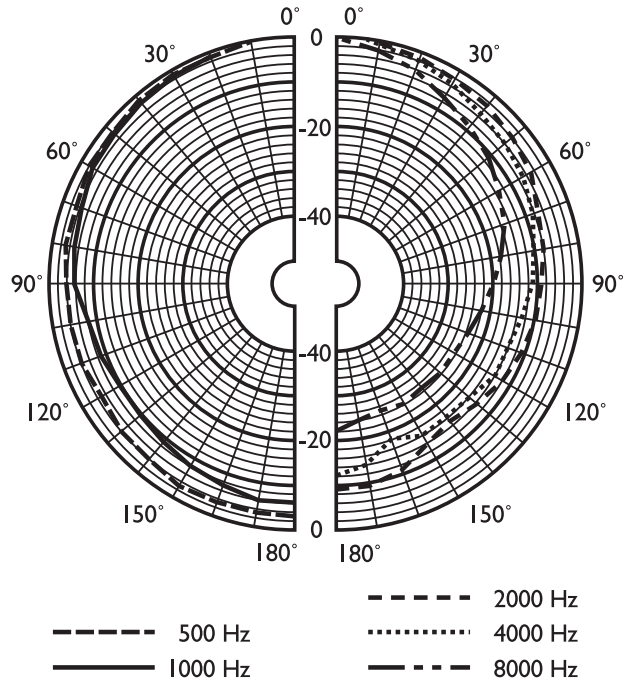

Polar diagram (measured with pink noise)

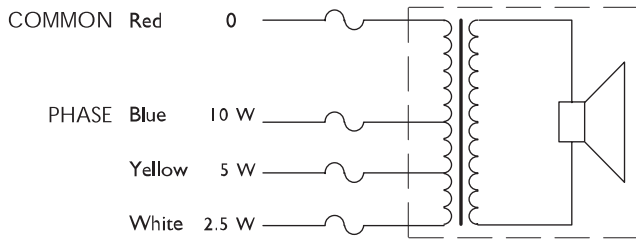

Circuit diagram

Octave band (Hz)	125	250	500	1k	2k	4k	8k
SPL 1.1	80	85	84	89	89	85	85
SPL max.	90	95	94	99	99	95	95
Q-factor	1.2	1.3	1.8	3.1	5.2	8.5	18
Efficiency	0.1	0.3	0.2	0.3	0.2	0.05	0.02
Hor. angle	360	360	360	180	125	90	55
Vert. angle	360	360	360	180	125	90	55

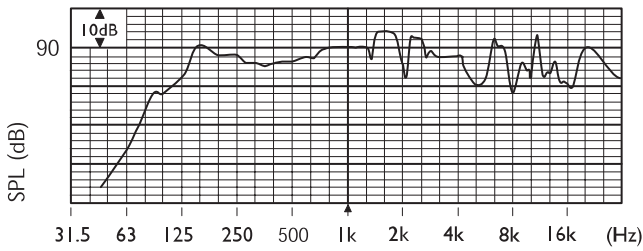

Frequency response

Technical Specifications**Electrical***

Max Power	15 W
Rated Power (PHC)	10 W (10 - 5 - 2.5 W)
Sound Pressure Level at 10 W/1 W (at 1 kHz, 1 m)	99dB / 89dB (SPL)
Effective Frequency Range (-10 dB)	130 Hz to 20 kHz
Opening angle (at 1 kHz/4 kHz, -6 dB)	180° / 90°
Rated Voltage	100 V
Rated Impedance	1000 ohm

Mechanical**Connection**

Cable	4-wire
Length	5 m

Dimensions

dia.	185 mm
Max length	157 mm
Color	off-white (PH 90019)
Weight	2.5 kg

Environmental

Ambient Temperature Range	-25 to +55 °C
---------------------------	---------------

*) Technical performance data acc. to IEC 60268-5

Ordering Information**Model & Description**

LBC 3095/15 Pendant Sphere Loudspeaker
10 W, white ABS

LBC 1256/00 EVAC Connection Adapter
3-pole screw connector

Americas:

Bosch Security Systems
130 Perinton Parkway
Fairport, New York, 14450, USA
Phone: +1 585 223 4060
+1 800 289 0096
security.sales@us.bosch.com
<http://www.boschsecurity.us>

Europe, Middle East, Africa:

Bosch Security Systems B.V.
P.O. Box 80002
5600 JB Eindhoven, The Netherlands
Phone: +31 (0) 40 27 83955
Fax: +31 (0) 40 27 86668
emea.securitysystems@bosch.com
<http://www.boschsecurity.com>

Asia-Pacific:

Bosch Security Systems Pte Ltd
38C Jalan Pemimpin
Singapore 577180
Phone: +65 6319 3450
Fax: +65 6319 3499
apr.securitysystems@bosch.com
<http://www.boschsecurity.com>

BOSCH